

17.224.XX

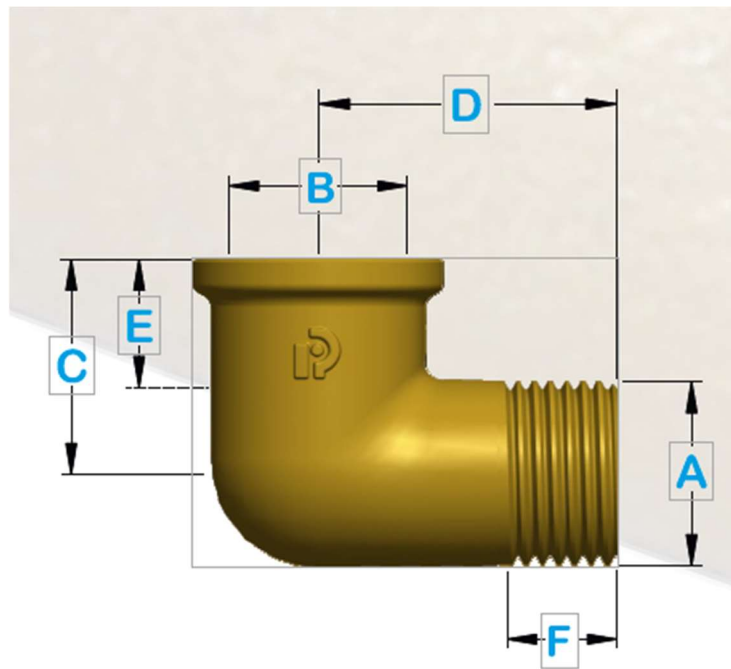

codice / code	A	B	C	D	E	F	weight [g]	finishing
17.224.09	1/4"	1/4"	19	30	12	11	37	sand blasted
17.224.02	3/4"	3/4"	27	39.5	14	13	114	sand blasted
17.224.03	1"	1"	31.5	49.5	16.5	16	193	sand blasted
17.224.04	1"1/4	1"1/4	48	48	15	17	300	sand blasted
17.224.05	1"1/2	1"1/2	50	50.5	17.5	20	381	sand blasted